

<b>04GAB0458</b>	
Light Source	4x3W
Lens	FB13B6
Selected Degree (°)θ1/2	24°
Input Voltage (V)	DC 24
Operating Current (MA)	24V=550
Consumption (W)	24V=13.2
Luminance (LM)	VWV=1345
IK	08

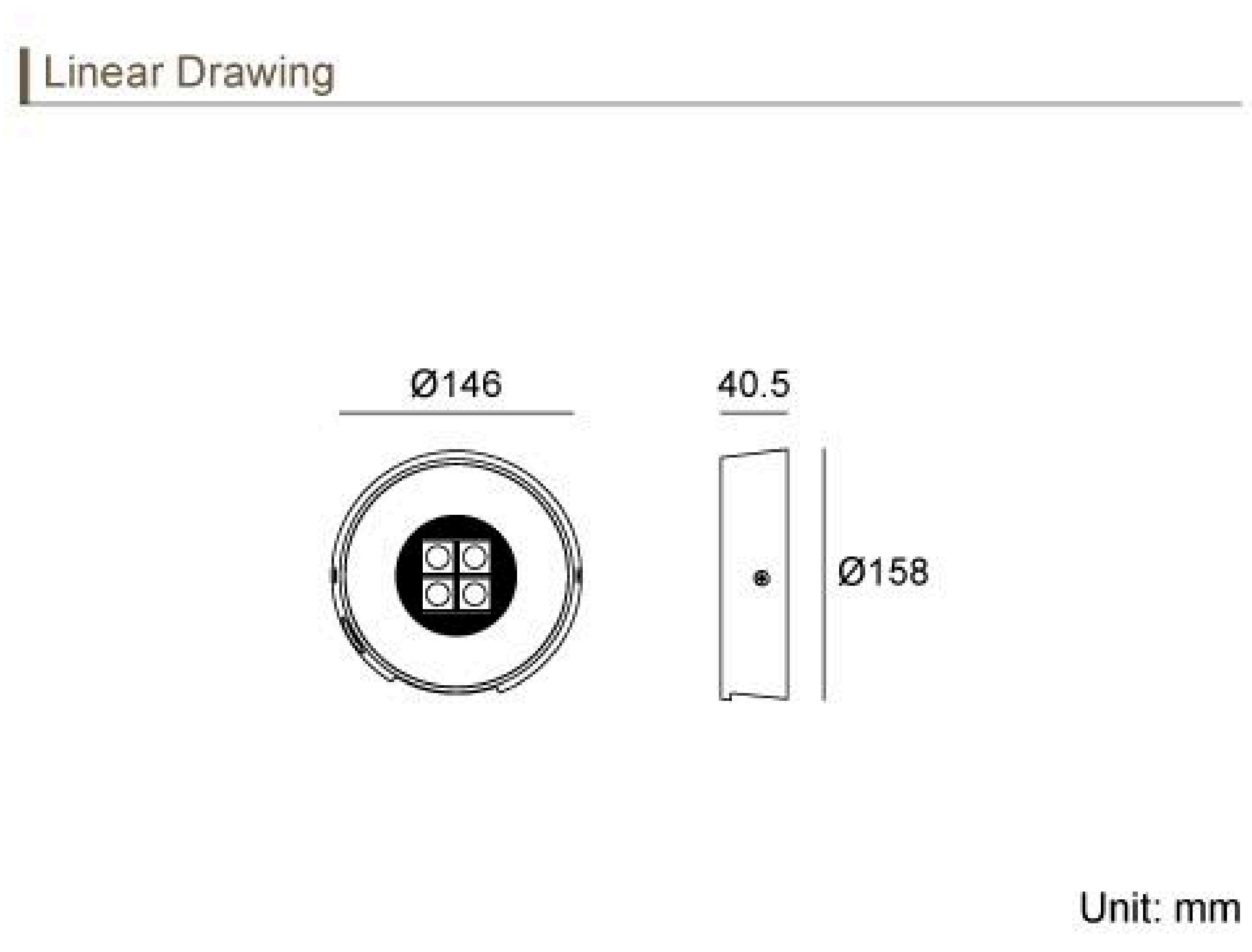

**Specification**

Housing	Hard chromeplated molding shaped stainless steel 316#
Front Cover	Hard chromeplated Stainless steel 316L#
Light Window	Step tempered Glass. T=8mm.
Cable Gland	IP68 PG-13.5 copper with nickel-coated
Gasket	Silicone Gasket
Operating Temperature	Temperature of water between -20°C~40°C Less than 2 meter depth
PCB	Excellen theat conductivity aluminum. coefficient of heat Conductivity≥2.0w/mk
LED Typet	SMD
LED Driver	Built in on/off driver
Glass Pressure Capacity	1078 kgs
Built-In Overheat Sensor System	Automatic Shutdown at 75°C
Power Cable Optional	H07RN-F 2×1.0mm <sup>2</sup> with water-stopper, L=1m, 3m, 5m
Dimming Support	External DALI supported TRIAC,0-10V, PWM via external driver on request

**Lens (Item Code)**      **Referenced Degree(°)θ1/2**

FB13B6	24 °(B15A:20°) 35°(B15A:28°) 50°(B15A:30°)
--------	--

**Water proof Solution**

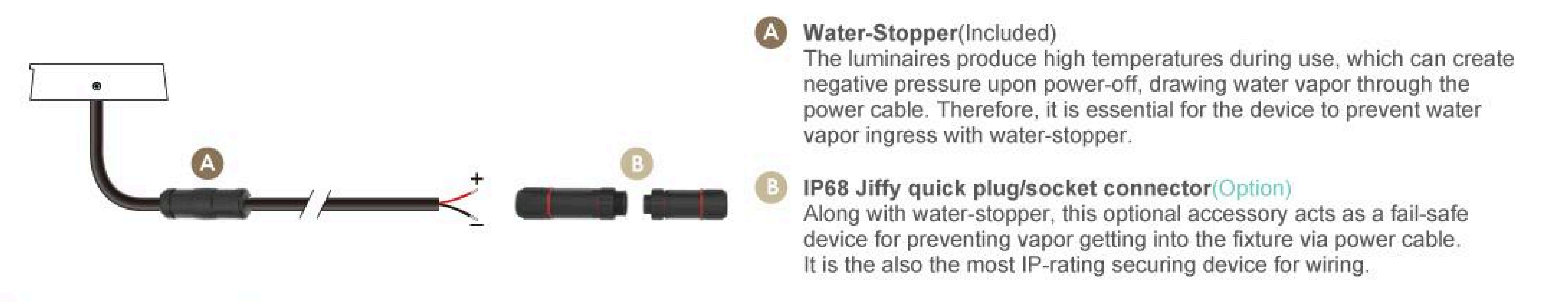

**Installation types by different wiring**

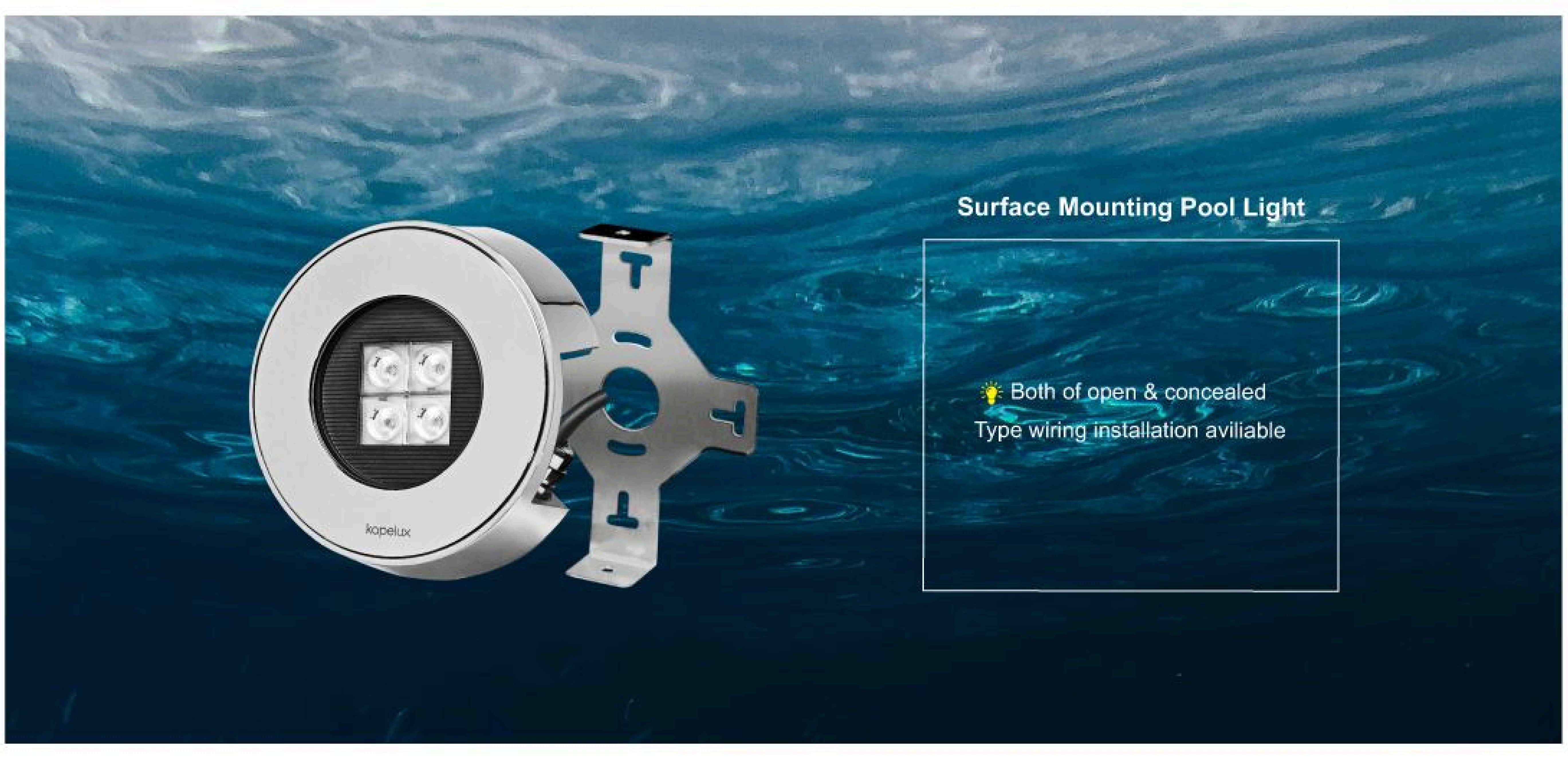
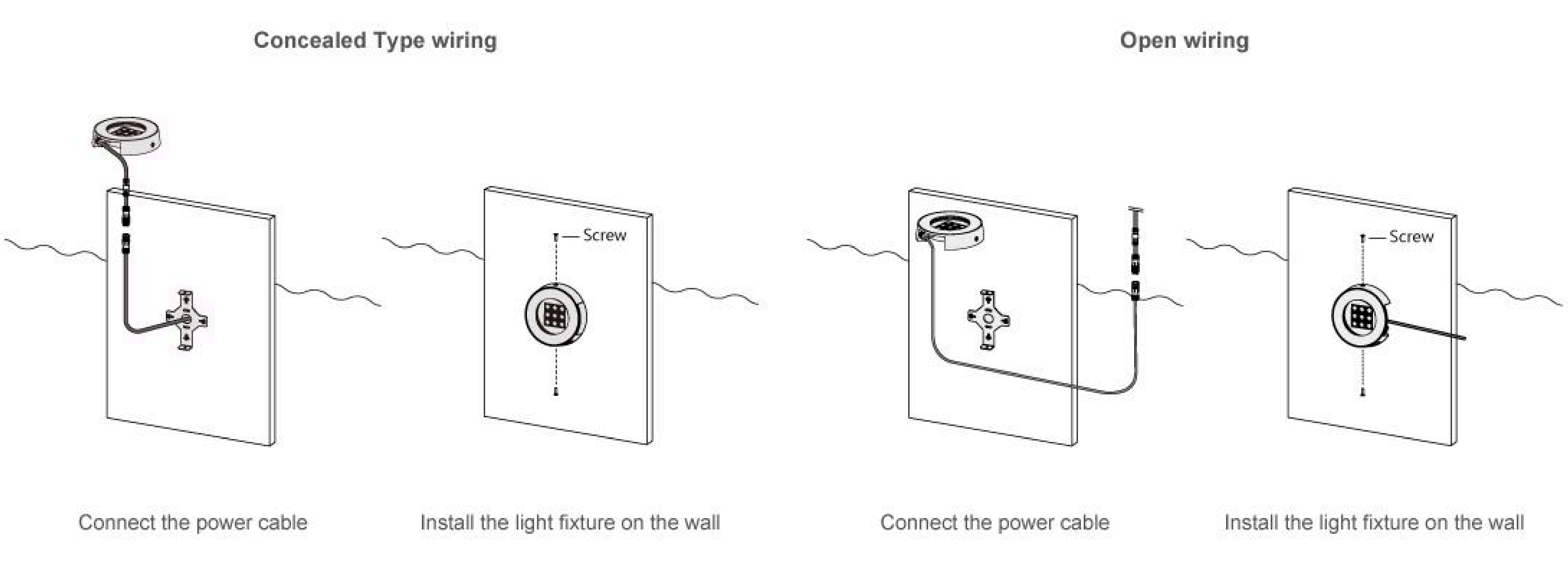

**Photometric**

