

01AJD0634

Light Source	6x0.5W
Lens	N/A
Selected Degree (°)θ1/2	N/A
Input Voltage (V)	DC 24 AC 120 240
Operating Current (mA)	24V=100 120V=48 240V=27
Consumption (W)	24V=2.4 120V=3.3 240V=3.4
Luminance (LM)	WW=48
IK	07

Specification

Front Cover & Housing	12# Die-casting RAL9005 powder coated aluminum T=60-80um Adhesion of ISO class 1/ASTM class 4B
Light Window	UV stop & flame resistant PC
Gasket	Waterproof silicone gasket
Cable Gland	IP67
LED Type	SMD
Driver	Built in on/off driver
Recessed Sleeve	PC/ABS ALLOYS 216#
Operating Temperature	-20°C-40°C
Power Cable	Outside of luminaire (Without waterstopper) DC power: H05RN-F 2x1.0mm ² , L=0.3m(24V) AC power: H05RN-F 3x1.0mm ² , L=0.3m(120V/240V)
Dimming Support	External DALI supported TRIAC, 0-10V, PWM via external driver on request

Sleeve

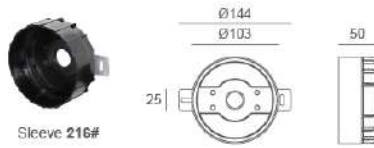

Sleeve 216#

Diagram Of Instruction

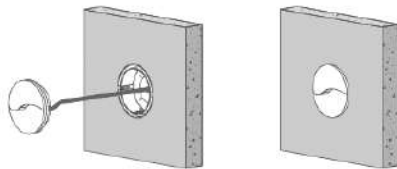

Linear Drawing

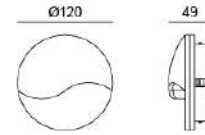

Unit: mm

Painting Color

Primary



Sanded Black
RAL 9005

Secondary



Sanded Dark Grey
KAP 7037



Sanded White
RAL 9003



Sanded Bronze
KAP 7008

Features

Screwless front cover



Use the high-strength clips for installation and extension.
(please refer remark ① & ②)



Photometric

1m	0.81 LLUX
1m	0.32 LLUX
2m	0.20 LLUX
3m	0.16 LLUX
4m	0.13 LLUX
5m	0.10 LLUX
6m	0.08 LLUX
7m	0.07 LLUX
8m	0.06 LLUX
9m	0.05 LLUX
10m	0.04 LLUX

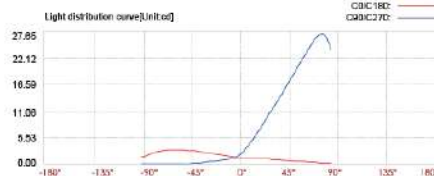

Distance (m)	Center beam LLUX	Beam width V (m)	Beam width H (m)
1m	0.38 LLUX	1.5m	1.8m
4m	0.10 LLUX	9.0m	5.4m
6m	0.04 LLUX	13.5m	5.4m
8m	0.02 LLUX	18.0m	7.2m
10m	0.01 LLUX	22.5m	9.0m
12m	0.01 LLUX	27.0m	10.8m